



# Motif Roam<sup>TM</sup> Operational Manual

## 1. Introduction

# Meet The Motif Roam™

Introducing the Motif Roam™ our durable, flexible breast pump designed for busy moms. Featuring specialized modes developed by Lactation Professionals, it supports your unique pumping journey. Compact and portable, the Roam is perfect for pumping anytime, anywhere.

All Motif Medical® products purchased from authorized retailers come with a manufacturer's warranty stating that product will be free from defects in workmanship and materials; for 2-years on breast pumps, for 1-year on internal batteries, and for 90-days on breast pump parts.

**Be sure to register your breast pump upon receiving it:**  
[motifmedical.com/warranty-registration/](https://motifmedical.com/warranty-registration/)



# Index

1.	Introduction	2
2.	Highlights	7
3.	Intended Use (Indications for Use)	8
4.	Symbols	9
5.	Safety	11
5.1	Prohibitions, Warnings, and Cautions	11
6.	Parts	14
6.1	What's Included	14
6.2	Buttons and Features	16
6.3	Battery Information	18
6.4	Settings and Modes	19
7.	Sterilization and Cleaning	21
8.	Operating Your Breast Pump	24
8.1	Breast Shield Sizing	24
8.2	Assembling Your Collection Cups	27
8.3	Turning The Motif Roam™ Pump On/Off	28

9.	Using Your Motif Roam™ Pump	29
9.1	Pumping Guide	29
9.2	Getting Ready to Pump	29
9.3	Aligning The Breast Shield	30
9.4	Expressing Your Milk	31
9.5	After Pumping	33
9.6	Storing Breast Milk	34
10.	Troubleshooting	36
10.1	Troubleshooting	36
10.2	Disposal	38
10.3	When to Replace Parts	39
11.	Technical Information	41
12.	Warranty	42



## 2. Highlights

Compact and portable, the Roam is perfect for moms on the go. Built with durability in mind, it can handle the demands of daily pumping while providing the flexibility you need to pump whenever and wherever life takes you.

### **New Pumping Modes**

Includes two custom modes, designed by a lactation professional, to maximize milk collection and minimize the time spent adjusting pump settings.

### **Rechargeable Battery**

With a battery life of 120 minutes between charges, the Motif Roam is portable, allowing for ease of use while pumping on the go.

### **Wearable Collection Cups**

Ultra-lightweight, discreet, and leak-proof 5 oz cups designed to fit comfortably in your bra.

### **Hands-Free Operation**

Use the included, detachable lanyard to hang your pump around your neck for hands-free pumping.

### **Super Lightweight**

Weighs less than a pound for perfect portability.

### **Closed System**

Backflow protection keeps the motor clean, preventing contamination.

### **Backlit LCD Screen**

Easy-to-read screen that won't strain your eyes.

### **Quiet Motor**

A low hum that won't wake your baby.

### 3. Intended Use (Indications for Use)

The Motif Roam™ Breast Pump is intended for use by lactating women to express and collect breast milk. The Motif Roam™ can be used as a single or double pump and is only intended for personal use.

Please read this document completely and follow the instructions exactly. To prevent personal injury and material damage, please observe the warning and safety information provided in this document.



---

**Warning: To avoid minor injury**

- Sharing a breast pump can cause health hazards and void manufacturer's warranty.



## 4. Symbols



**Warning:** Potentially dangerous situation that could result in serious injury



**Caution:** A possibly dangerous situation that could result in slight bodily injury



**Notice:** Useful information or information you need to know when using this product



**Manufacturer**



**Date of manufacture**



**Serial number**



**Manufacturer's catalog number**



**Refer to instruction manual**

**IP21** Ingress protection



**Battery State**



**DC**



**Transport / Storage Humidity**



**Operation Humidity**



**Operation Temperature**



**Storage Temperature**



**Operating Pressure**



**Transport / Storage Pressure**

#### 4. SYMBOLS



**Fragile**



**Do not pile**



**This way up**



**Keep Dry**



**Good Manufacturing Practice Logo**



**Type BF applied part**



**This product should not be mixed with other commercial waste for disposal**



**Power**



**Increases level of suction**



**Decreases level of suction**



**Mode Button**

## 5. Safety

### 5.1 Prohibitions, Warnings, and Cautions



#### **Warning: To prevent voiding of warranty**

---

- Do not modify this equipment without authorization of the manufacturer.
- Do not disassemble or modify the product. The device has no user-serviceable parts.
- Use of power adapters other than those specified in this user manual can cause internal damage to the pump or cause the pump to function improperly. Therefore, using other power adapters will void your Motif warranty.



#### **Warning: To reduce the risk of electrocution**

---

- Always unplug immediately after use.
- Do not use while bathing.
- Do not place or store product where it can fall or be pulled into a tub or sink.
- Do not place or drop into water or other liquid.
- Do not reach for a product if it has fallen into water. Immediately unplug from electrical outlet.



#### **Warning: To avoid fire, electrocution, or serious burns**

---

- Do not leave the product unattended when plugged into an electrical outlet.
- Close supervision is necessary when this product is used near children or persons with disabilities.
- Place product out of reach of children.
- Use the product only for its intended use as described in this manual. Do not use attachments not recommended by the manufacturer.
- Never operate this product if it has a damaged cord or plug, if it is not working properly, or if it has been dropped or damaged, or dropped into water.
- Keep cord away from heated surfaces.
- Never use while sleeping or when drowsy.

- Never drop or insert any object into any opening or tubing.
- Do not use outdoors, or operate where aerosol (spray) products are being used where oxygen is being administered.
- Always inspect power adapter wires prior to use for damage or exposed wire. If damage is found, immediately discontinue use of power adapter and call Motif Medical® Customer Service.
- The Motif Medical® Twist should not be positioned so that it is difficult to operate the power adapter.



### **Warning: To avoid health risk and reduce the risk of injury**

---

- If you are a mother who is infected with Hepatitis B, Hepatitis C or Human Immunodeficiency Virus (HIV) pumping breast milk will not reduce or remove the risk of transmitting the virus to your baby through your breast milk.
- Before each use visually inspect the individual components for cracks, chips, tears, discoloration or deterioration. In the event that damage to the device is observed, please discontinue use until the parts have been replaced.
- This product is the intended for use by a single user only and should not be shared between users.
- Do not drive while pumping.
- Never use while pregnant, as pumping can induce labor.
- Clean and sanitize all parts that come in contact with your breast and breast milk prior to first use.
- Wash all parts that come in contact with your breast and breast milk after every use.
- Do not continue pumping for more than 2 consecutive pumping session if no results are achieved.
- Do not thaw frozen breast milk in a microwave or in a pan of boiling water.
- If tubing becomes moldy, discontinue use and replace with new tubing.
- If breast milk backup occurs you must clean tubing before your next pumping session.



### **Caution: To avoid minor injury**

---

- Do not wrap cord around power adapter body.
- Use only the power adapter that comes with the powered breast pump.
- Pump only with the breast pump in an upright position.
- Do not shorten tubing.
- Make sure the voltage of the power adapter is compatible with the power source.
- Plug the power adapter into the breast pump first and then into the wall socket.
- Do not use antibacterial or abrasive cleaners/detergents when cleaning the breast pump or breast pump parts.
- Never put the breast pump motor in water or sterilizer as you can cause permanent damage to the breast pump.
- Do not attempt to remove the breast shield from your breast while pumping. Turn the breast pump off and break the seal between your breast and breast shield with your finger, then remove breast shield from your breast.
- If pumping is uncomfortable or causing pain, turn the unit off, break the seal between the breast and breast shield with your finger, and remove the breast shield from your breast.
- Breast pump parts become brittle when frozen and may break when dropped.
- Breast pump parts may become damaged if mishandled, e.g. dropped, over-tightened or knocked over.
- Take appropriate care in handling breast pump parts.
- Do not use the breast milk if breast pump parts become damaged.

## 6. Parts

### 6.1 What's Included

**i** While unpacking the box, make sure all of the following components are enclosed.

- 1 Breast Pump Motor (1)
- 2 Tubing (2)
- 3 Tubing Connector (2)
- 4 Diaphragm (2)
- 5 Collection Cup (2)
- 6 Breast Shield (2)
- 7 Valve (4)
- 8 Power Adapter (1)
- 9 Flange Inserts (16 mm, 19 mm, 21 mm, 24 mm)
- 10 USB Charging Cable (1)

Not Pictured:  
Lanyard (1)

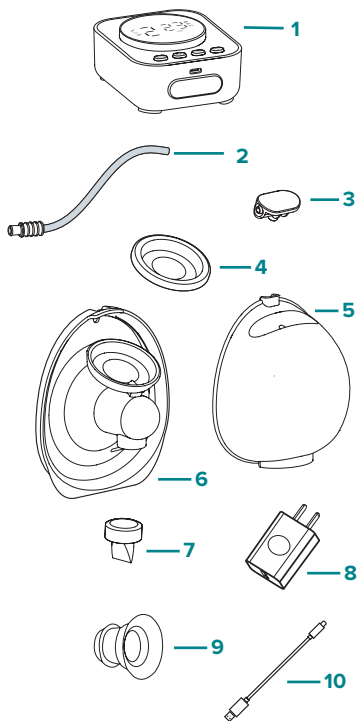

**Additional accessories and parts available for the Motif Roam breast pump:**

- Full resupply kit with replacement parts
- Individual parts
- Full resupply kit with bottles and flanges
- Flange inserts: 13 mm, 15 mm
- Motif Roam bottles
- Motif Roam nipples



**Find replacement parts and additional supplies for the Motif Roam at:**  
**[motifmedical.com/replacement-supplies/](https://motifmedical.com/replacement-supplies/)**

## 6.2 Buttons and Features

### LCD SCREEN

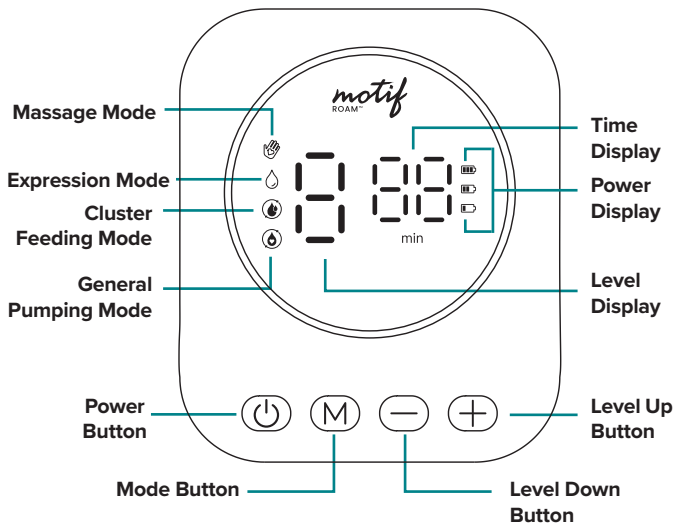



## BUTTON CONTROL

### **Power Button**

---

Long hold the power button to turn the pump on or off.

Short press to pause or unpaue the pump.

### **Mode Button**

---

Short press to switch between pumping modes.

### **Level Up Button**

---

Short press to increase the vacuum (suction) level during any mode.

### **Level Down Button**

---

Short press to decrease the vacuum (suction) level during any mode.

## 6.3 Battery Information

### DIFFERENT LEVELS OF CHARGE

---



**Low Battery**



**1/3 Charge**

*Connect USB  
cable soon*



**2/3 Charge**



**Full Charge**

*Operating time:  
approx. 120 min*



Charge the battery as soon as there is 0-30% charge remaining. If the battery dies, your Motif Roam will automatically shut down. Do not use the pump when charging.



It is recommended to charge your pump after each use when possible. Only charge your Motif Roam using the provided power adapter.

## 6.4 Settings and Modes

### Suction Settings

The suction level on your breast pump refers to the suction strength. When you are using your Motif Roam™, you will usually find that expressing is most effective on the highest suction level that you are comfortable with.

It is important not to set the suction level so high that it makes you uncomfortable, as the resulting pain will hinder your milk flow.

The Motif Roam™ has 4 pumping modes. Massage and Cluster Feeding Modes have 5 levels. Expression and General Pumping modes have 9 levels.

### Standard Modes

Classic modes for efficient let down and milk expression.



#### Massage Mode

---

Suction pattern with fast cycles and low vacuum to help with letdown and to start the flow of milk.

- Massage Mode has 5 suction levels



#### Expression Mode

---

Suction pattern with slower cycles and higher vacuum to express milk gently and efficiently.

- Expression Mode has 9 suction levels

## Specialized Modes

The Motif Roam™ includes two custom modes, designed by a lactation professional, to maximize milk collection and minimize the time spent adjusting pump settings.



### Cluster Feeding Mode

---

Mini power pumping mode that imitates a newborn's cluster feeding to help boost milk supply. Cluster feeding naturally occurs when a baby breastfeeds multiple times within a short period of time only taking quick breaks, signaling the body to produce more milk. Within each level, this mode includes 3 pumping steps with pauses of low suction in between.

- Cluster Feeding Mode has 5 suction levels



### General Pumping Mode

---

Mode for everyday use that begins in massage mode and switches to expression mode after 2 minutes. This repeats twice for 2 letdowns.

After pumping with standard massage and expression modes on this pump, use the same expression mode level with the general pumping mode for the same suction strength.

- General Pumping Mode has 9 suction levels

## 7. Sterilization and Cleaning



**Before initial use sterilize each part of the:**

- Diaphragms
- Valves
- Collection Cups
- Flange Inserts
- Breast Shields

**\*Do not sterilize or wash the tubing or tubing connectors.**

Repeat sterilization of listed parts once daily after pump use.

### Sterilization Instructions

1. If parts have been used previously, follow cleaning instructions first.
2. Place your collection cup parts in a pot and cover them with water.
3. Bring water to a boil and let boil for five minutes.
4. Remove parts with clean tongs.
5. Place collection cup parts on a clean paper towel or dish towel and allow to air dry completely.



**Parts can also be sterilized in a steam sterilizer or microwave sterilization bag to sterilize collection cup parts quickly and efficiently.**



**Be sure not to place tubing into the Sterilizer Bags in attempt to clean the tubing.**

### Cleaning Instructions

1. Thoroughly wash your hands with soap and warm water.
2. Disassemble each collection cup part that came into contact with breast milk. This includes valves, diaphragms, breast shields, collection cups, and flange inserts. **\*Do not clean the tubing. If moisture or milk becomes present in the tubing, replace it as soon as possible. Do wash and hang it to dry if you need to use it again before replacing. Ensure the tubing is dry before use. Moisture in the tubing could be pulled into the pump and damage the motor.**
3. Rinse each part with cool water to remove milk residue.
4. Options for washing pump parts:
  - Separately wash each part in the sink with a soft brush and soap. (Be sure to use a new brush or washcloth exclusively for breast pump parts.)
  - Soak each part in warm, soapy water for 5 minutes and then thoroughly rinse them.
5. Dry each part with a clean towel or allow to fully air dry on a sanitary surface such as a clean paper towel or clean dish towel. Do not pat dry.
6. Wipe the outside of your breast pump with a dry, clean towel. **\*Do not wash the outside of your breast pump with water or get your breast pump wet when cleaning it.**



**It is not recommended to wash and dry Motif Breast Pump parts in the dishwasher. There is no standard temperature for dishwashers and some may warp parts. Parts damaged in the dishwasher are not covered under warranty.**

### After Every Use

1. Thoroughly wash your hands before handling each collection cup component.
2. Disassemble each part that comes into contact with breast milk including the valve, diaphragm, breast shield, collection cup, and flange insert.
3. Rinse each part in cool water to remove milk residue.
4. Options for washing individual parts:
  - Separately wash each part with a soft brush or a clean dishcloth.
  - Soak each part in warm soapy water for 5 minutes then thoroughly rinse them.
5. Dry each part with a clean towel and/or allow them to completely air dry on a sanitary surface.
6. Wipe the main body with a dry, clean towel after each use.  
\*Never use water to wash the outside of your breast pump.
7. Store parts after they completely dry in a clean bag or container. \*Do not store any damp parts.

## 8. Operating Your Breast Pump

### 8.1 Breast Shield Sizing

#### Understanding size

Pumping should not hurt. This guide is a starting point to help determine your optimal breast shield size based on your nipple diameter.

#### How To Find The Right Size Breast Shield For You

##### Step 1

Using a ruler, measuring tape, or flange sizing tool, measure your nipple diameter at the widest part (usually the base) in millimeters (mm). Measure before pumping. **Do not include any areola.** It is important to measure both nipples as they may be different sizes.

##### Step 2

Add 0-3 mm to your nipple size to find your breast shield size. Your nipple should move easily in the breast shield tunnel and no areola or other breast tissue should enter the breast shield tunnel. You may need to try more than one size to find the most comfortable and effective fit.

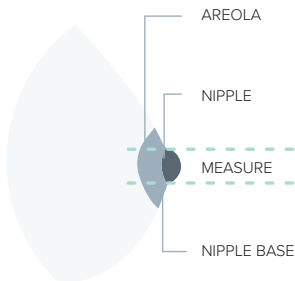

*Example: If your nipple diameter measures 16 mm your breast shield sizing range would be 16mm-19mm.*

\*1 cm = 10 mm



See below for the recommended breast shield size based on your measurements. Most mothers find that adding 0-3mm to their nipple measurement results in a comfortable and effective flange fit.

## TEST YOUR BREAST SHIELD SIZE

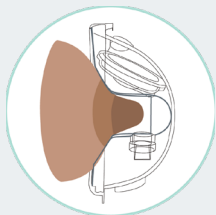

### Good Fit

Pumping is comfortable and effective.

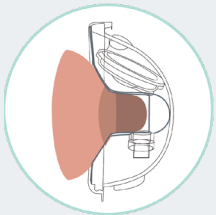

### Too Small

Painful rubbing.  
Try a larger size.

## FLANGE SIZE CHART

Flange	Fits Nipples
13	10-13 mm
14	11-14 mm
15	12-15 mm
16	13-16 mm
17	14-17 mm
19	16-19 mm
21	18-21 mm
24	21-24 mm
27	24-27 mm
28	25-28 mm

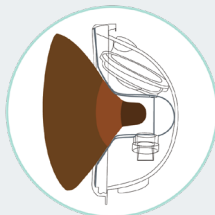

### Too Large

Aerola is being pulled into the flange tunnel. Only the nipple should enter the flange tunnel.

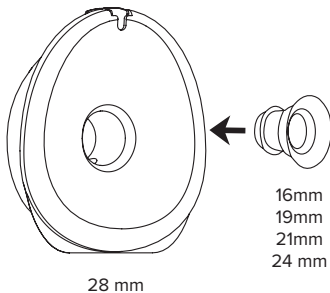

### Finding Your Flange Size

The breast shield for the collection cups is 28 mm. Box also includes 16 mm/19 mm/21 mm/ 24 mm flange inserts. If needed, push the insert of the correct size into the breast shield for a smaller fit.

### Should you try a new breast shield or flange insert size?

- Does your nipple rub sides of the tunnel to the point of causing discomfort?
- Do you see excessive areola being pulled into the tunnel?
- Do you see any redness?
- Is your nipple or areola turning white?
- Do you feel unexpressed milk after pumping?

If you answered “YES” to any of these questions, consider trying a new size by following the measuring instructions above.

If you are still unsure if you selected the correct size, see a lactation consultant, or breastfeeding specialist for assistance in choosing the right size breast shield.

## 8.2 Assembling The Collection Cups

Before use, ensure your hands and the collection cups are clean.

1. Push flange insert into breast shield, if using. Insert should be flush with the breast shield.

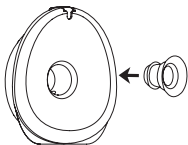

2. Push the silicone duckbill valve into the breast shield.

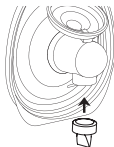

3. Put diaphragm into the breast shield. Make sure it is sealed around the edge.

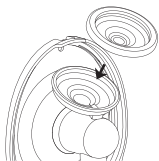

4. Insert the spout on collection cup into the hole at the top of the breast shield. Push the collection cup into the breast shield. There should be an audible 'click'.

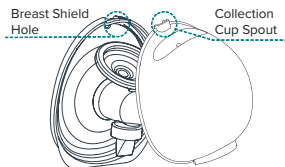

5. Insert the tubing into the tubing connector and attach to the collection cup.

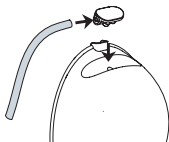

6. Insert the tubing with connectors into one or two pump ports to single or double pump. When single pumping, block the other port.



Single Pumping



Double Pumping

## 8.3 Turning The Motif Roam Pump On/Off



### **Press the POWER button**

Long press the power button to turn the pump on. The screen will light up and the pump will begin in Massage Mode in level 1.



### **Press the MODE button**

Press the mode button to change modes



### **Adjust suction level to preferred comfort level**



### **Press the POWER button**

When you wish to stop expressing, long press the power button to turn the pump off. Detach the tubing from the cup and remove the cup from your breast.



### **Charge the battery immediately when the battery symbol is flashing on the screen.**

If the breast pump remains unused for a long period of time, make sure that the battery is fully charged before use. Unplug the power adapter from the breast pump immediately after you are finished charging your device.

## 9. Using Your Motif Roam™ Pump

### 9.1 Pumping Guide



**Even when you are using the breast pump, it is recommended to breastfeed your baby whenever you can.**

- Gently massage your breasts or apply warm compresses from the breast toward the nipple before starting your pumping session.
- Express milk from each breast for 10 - 15 minutes. It is recommended to pump frequently rather than pumping for a long duration. (Every 2 - 3 hours, 8 times a day.)

### 9.2 Getting Ready to Pump

1. Check to see if you are using the correct size breast shield or insert. See section 8.1 for more details.
2. Check battery level before use to ensure the pump is fully charged.
3. Wash hands thoroughly.
4. Check each component for wear or damage before use and replace parts when/if necessary.
5. Assemble the collection cups and attach them to your breast pump via the tubing as described in section 8.2 Assembling the Collection Cups.
6. Ensure the tubing is tightly connected to prevent air leakage.
7. Place the collection cups on your breast underneath your bra. Adjust the length of the bra straps to make suction more comfortable.

## 9.3 Aligning The Breast Shield

Center the breast shield on your breast so that the nipple is drawn into the breast shield tunnel.

It's important that the breast shield is positioned properly before pumping begins to avoid any pain that may be caused by rubbing or twisting of your nipple onto the side of the breast shield. If double pumping, place the second breast shield in place as well.

If you're concerned about the fit or want to ensure you've placed the breast shield on correctly, please reference the "Test your breast shield size" portion of Section 8.1 Breast Shield Sizing.

While some discomfort may be felt when first using a breast pump, using a breast pump should not cause pain. If you are unsure about breast shield sizing, please contact a healthcare professional or Motif Medical® representative who can help you get a proper fit.

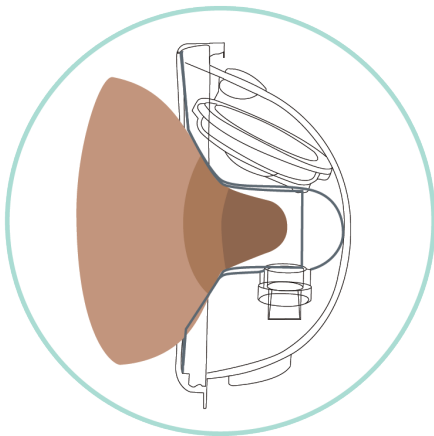

## 9.4 Expressing Your Milk

1. Long press the power button (🔌) to start pumping. The breast pump begins in massage mode in level 1.



2. Press the Mode (M) button to switch modes. There are four modes: Massage (👉), Expression (💧), Cluster Feeding (⬢), and General Pumping (⬤).



3. Adjust the suction strength by pressing the LEVEL UP (+) or LEVEL DOWN (−) button to find a comfortable setting. Massage and Cluster Feeding modes have 5 levels, while Expression and General Pumping modes have 9 levels.



4. When your pumping session is over, long press the power (⏻) button to turn the breast pump off. Please note, the pump will automatically stop after 30 mins.





## 9.5 After Pumping

1. After your pumping session, turn off the breast pump.
2. Carefully remove the tubing connector from the cup while it is still in the bra.
3. Slide a finger between your breast and the breast shield to separate them. Remove the collection cup from your bra, keeping the collection cup upright to avoid spilling breast milk.
4. With the breast shield facing up, gently pour the milk into a bottle or collection container through the pour spout at the top of the cup.

After each pumping session, be sure to take apart the assembly. Never attempt to clean or sterilize pump parts when still assembled to ensure you are cleaning and sterilizing each part individually.



**Do not store milk in the collection cup.**



**Do not wrap tubing around the breast pump to store.**

## 9.6 Storing Breast Milk

- i** When storing breast milk in a milk storage bag, make sure to only use non-toxic markers when writing on the bag.

		Storage Locations / Temperatures		
		Room Temperature 77°F (25°C) or colder	Refrigerator 40°F (4°C)	Freezer 0°F (-18°C) or colder
Type of Breast Milk	Freshly expressed or pumped	0 - 4 hrs	0 - 4 days	0 - 6 mo. is best  6 - 12 mo. is acceptable
	Thawed (previously frozen)	1-2 hrs	0 - 24 hours (one day)	<b>* Never refreeze human milk after it has been thawed</b>
	Leftover from a Feeding (baby did not finish the bottle)	0 - 2 hrs after the baby is finished feeding		

Source: CDC.gov

## How to Thaw Breast Milk

1. Always make sure to check the date on the milk's container before using. Do not use undated milk, or milk that has been stored longer than recommended.
2. Thaw frozen milk in the refrigerator or under cool, running water.
3. Heat the milk under warm, running water and gently swirl the container to mix the milk. Be sure not to shake the bottle.
4. If warm water is not available, heat a pot of water on the stove. Once the water is warm, not boiling, remove the pot from the stove and place milk container in the pot. Never warm the milk container directly on the stove.
5. Never microwave breast milk because microwaves can cause dangerous hot spots that could burn you or your baby.
6. Always test the temperature of the milk on the inside of your wrist before feeding it to baby. The milk should feel warm, not hot.
7. After thawing, milk should be stored in the refrigerator for no more than 24 hours.
8. Never refreeze thawed milk. Throw away previously frozen milk that is not used within 24 hours.

## 10. Troubleshooting

### 10.1 Troubleshooting

Below you will find general conditions that may occur with your Motif Roam™ and corresponding troubleshooting solutions.

Condition	Possible Causes	Checks	Solutions
No power	Power Adapter	Check if the power cord is not connected or is damaged.	Plug into the outlet. If it has damage, contact Motif customer service at 844-272-8390 or where you purchased the pump.
No suction	Tubing	Check the tubing is connected to the main body.	Connect the tubing to the main body.
	Valve	Check if the valves are connected to breast shield properly.	Disassemble and reassemble them properly.
	Air Flow Port Plug	If single pumping, check if the air flow port plug is closed.	Close the air flow port plug.
	Diaphragm	Check if the diaphragm is stuck and will not release.	Lower the suction level
Main body becomes wet		Unplug the power adapter from the socket. Turn off the Breast Pump. Wipe the main body with a clean dry cloth and store it in a warm dry area for about 12 hours.	

Condition	Possible Causes	Checks	Solutions
Milk leakage	Breast Shield	Check if the breast shield and collection cup are connected properly	Disassemble and reassemble them properly.
Low suction	Suction Level	Check if there is a low vacuum level on the vacuum regulator valve or if there is an abnormal noise.	Contact Motif customer service at 844-272-8390.
	Defective Assembly Kit	Check the connection of the kit.	Disassemble and reassemble them.
	Breast Shield	Check if there is a problem with the breast shield.	Visit <a href="https://motifmedical.com">motifmedical.com</a>
	Valve	Check if there is damage in valve head.	Replace the valve.
Pain	Suction too high	Check the suction level.	Set to the lowest suction level and consult your lactation consultant or physician.
Breast milk in tubing		Turn off the breast pump. Disconnect the tubing from the diaphragm. Remove the milk and tubing from the diaphragm.	



**If you need additional help troubleshooting your breast pump, please reach out to the Motif Medical® Customer Service Department. You can access them online at [motifmedical.com](https://motifmedical.com) via chat, through email at [hello@motifmedical.com](mailto:hello@motifmedical.com) or by phone (844) 272-8390.**

## 10.2 Disposal

Please send components that are no longer used to Motif Medical® or properly dispose of the device in accordance with local, state, and federal regulations.



**As electrical and electronic equipment, the device must be disposed of according to a specialized procedure for collection, pick-up and recycling or destruction in accordance with Directive 2012/19/EU of the European Council on Waste Electrical and Electronic Equipment [WEEE].**

## 10.3 When to Replace Parts

How often you should replace your breast pump supplies such as collection cups can vary based on how often you use your breast pump. For example, a mom that exclusively breast pumps about 9 times a day and sanitizes their parts more frequently than a mom that only pumps 3 to 4 times per day will need to replace her parts more often.



**A good reference to keep in mind is replacing your parts every 90 days.**

### Replacing your Tubing

As the tubing becomes stretched and worn out over time it can impact your breast pump suction strength.

- If the tubing easily slides on and off the motor and backflow protector then it's time to replace it.
- You should also immediately replace the tubing if any moisture gets inside.
- There's no way to completely sterilize the tubing to prevent bacteria from collecting inside and the moisture could damage your breast pump motor.

### Replacing your Valves

The silicone valves need to be replaced between 1 to 3 months based on how frequently they're used because they can affect suction power.

- It's important to remember that smaller breast pump parts may not show any visible damage.

### **Replacing your Diaphragms**

The diaphragms may stretch and lose elasticity over time, making them less effective at keeping moisture out of your breast pump motor.

- They need to be replaced between 3 to 6 months depending on use.
- If you see any tearing, warping, rips, or discoloration then it's time to replace them.

### **Replacing your Breast Shields (Flanges) and Collection Cups**

Your breast shields will collect residue, can crack, or become discolored over time depending on how often you pump.

- They should be replaced every 6 months.
- However, keep an eye out for any cracks, tears, or warping because that could indicate that need to be replaced sooner.
- The discoloration will not affect how well your pump works but may not be pleasing to the eye.





### **Replacing your Silicone Inserts**

Your silicone inserts will collect residue, can crack, or become discolored over time depending on how often you pump.

- They should be replaced every 6 months.
- However, keep an eye out for any cracks, tears, or warping because that could indicate that need to be replaced sooner.
- The discoloration will not affect how well your pump works but may not be pleasing to the eye.

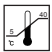

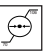
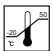
## 11. Technical Information

Contents	Description	
Rated voltage and frequency	Input: 5V	
Battery / Life	3.7 V, 3200 mAh, Lithium 120 mins	
Protection on electronic shock	Class II,  TYPE BF: Breast Shield	
Degree of protection against ingress of water	IP Classification: IP21	
General Pumping Features		
Operation Mode (Continuous operation)	Expression Mode, Massage Mode, Cluster Feeding Mode, General Pumping Mode	
Suction Levels	Massage Mode	1 - 5 Levels
	Expression Mode	1 - 9 Levels
	Cluster Feeding Mode	1 - 5 Levels
	General Pumping Mode	1 - 9 Levels
Suction Cycles	Fixed CPM	
Timer Function	Automatic Off (30 min ± 1 min)	
Noise	≤55 dB	
Backflow Protection	Yes	
Operating Conditions		
Ambient temperature	41 to 104°F	   Temperature Humidity Pressure
Relative humidity	20 to 80%	
Air pressure	85 to 106 kPa	
Transport and Storage Conditions		
Ambient temperature	-4 to 131°F	   Temperature Humidity Pressure
Relative humidity	20 to 80%	
Air pressure	90 to 106 kPa	

## 12. Warranty

**Be sure to register your pump upon receiving it at:  
[motifmedical.com/product-registration](https://motifmedical.com/product-registration)**

**All Motif Medical® products purchased from authorized retailers come with a manufacturer's warranty stating that product will be free from defects in workmanship and materials; for 2-years on double-electric breast pumps, for 1-year on internal batteries, and for 90-days on breast pump parts and the Manual Breast Pump.**

Motif's sole obligation under this express warranty shall be, at Motif's discretion, to replace or repair the product or part(s) thereof (in case the product is not available, to deliver a similar type of product).

The warranty starts on the proven purchase date and is a single warranty ending from this starting date. The warranty does not extend if the product is replaced. The warranty is non-transferable. Motif breast pumps are single-user pumps and the warranty only applies to the original pump user.

The warranty covers manufacturing defects. Motif Medical® cannot replace a pump part which was damaged by the end user while using the pump. The warranty does not cover lost or stolen items, normal wear and tear to breast pump parts, and items that are misused, abused or improperly stored. Failure to comply with operating instructions or alterations made to the product will result in the warranty being voided.

Warranty products are shipped using standard ground. Express; overnight and 2-day shipping are available for an additional fee. The warranty is valid in the United States only. Warranty items will only be shipped to addresses in the US.

 **If you have a warranty question, you can call 844-272-8390, visit us online at [motifmedical.com](https://motifmedical.com), or email customer service at [hello@motifmedical.com](mailto:hello@motifmedical.com)**



**Manufactured for:**

Motif Medical®, LLC  
8 The Green, Suite 5601  
Dover, DE 19901

**Phone:** (844) 272-8390

**Email:** [info@motifmedical.com](mailto:info@motifmedical.com)

**Web:** [www.motifmedical.com](http://www.motifmedical.com)

Thank you for choosing  
the Motif Roam<sup>TM</sup> Breast Pump

(844) 272-8390  
[info@MotifMedical.com](mailto:info@MotifMedical.com)  
[www.motifmedical.com](http://www.motifmedical.com)

Motif Medical®  
8 The Green, Suite 5601  
Dover, DE 19901