

# Motif BiliTouch™ Quick Guide

## 1. Warnings & Precautions



**Warning: To avoid health risk and reduce the risk of injury**

- Eye Protection: Do not look directly into the LED. During the treatment, always use eye protection to protect a baby's eyes.
- Periodically, check the hospital or treatment protocol and makes sure that the baby's eyes are protected from contamination.
- Patients near the light should use protective pads or equipment to protect their eyes.
- We recommend not swaddling your baby during therapy to reduce the risk of overheating. Should your unit set off an alarm, please stop therapy and let the light pad cool for 20 minutes before resuming therapy.



**Caution: Can lead to minor injury or product/property damage.**

- Use only Motif Medical® accessories.
- Check the eye protection and cover for wear or damage before use and replace them if necessary. Do not use them if there are signs of damage or defects.
- The eye protection and cover are disposable, multiple uses are prohibited.
- To maintain optimum performance, it is recommended to replace consumables periodically.

## 2. Parts, Buttons, & Functions

### Control Box

1. LCD Display
2. Operating Buttons
3. Control Unit
4. Power Adapter Terminal
5. Pad Connection Terminal
6. Power
7. Light Intensity Control Button
8. 30-Minute Increase Button
9. 30-Minute Decrease Button

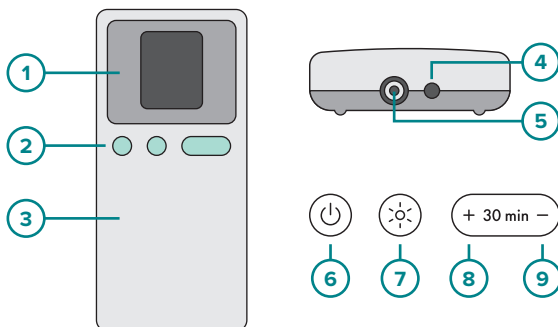

### LCD Screen

10. Temperature Warning
11. Charging Indicator
12. Battery Status and Low Battery Warning
13. Operating Time
14. Remaining Time
15. Light Intensity

### Light Pad

16. Light Pad
17. Temperature Sensor
18. Illuminated Area

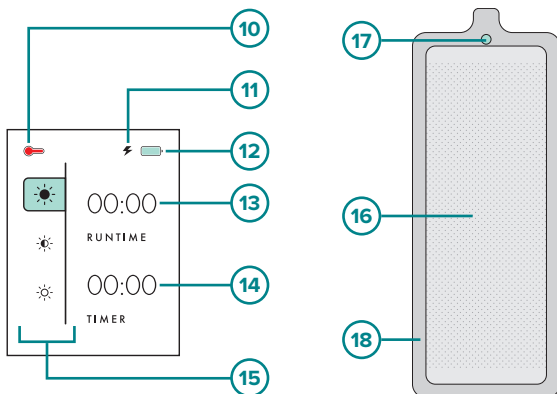

### 3. Preparing the Device and Patient

#### Before Use

1. Ensure the arrow symbols on the pad connector and the control box are aligned, then connect them. When disconnecting, pull the metal collar toward the light pad to disengage it.
2. Put the light pad in the disposable cover. The unpatterned area should touch the white side of the light pad. If you fold the light pad as shown in the picture and insert it, it would be easier. If the cover gets dirty during use, discard the cover and use a new one. If there is any foreign substance on the light pad, it must be washed according to “Chapter 6: Maintenance and Cleaning” before use.
3. Install the eye protection on the patient's eyes.

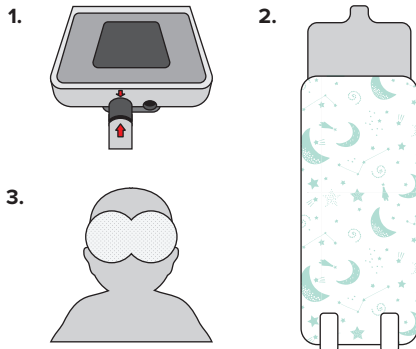

#### Patient Placement

4. As shown in the picture, place the patient on the light pad (with the cover on), the light emitting area of the pad should be face up. When a patient is on the light pad, be sure the patient's back is centered on the pad.
5. After folding the light pad in half, fix it with velcro. The power cord should be facing the floor.

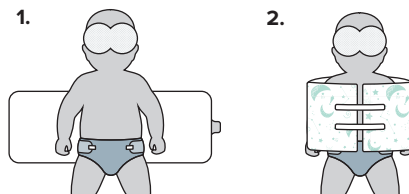

### 4. Using the Device

#### Using the Device in Normal Mode

Use the  button to set the intensity level and it will run continuously.

#### Using the Device in Timer Mode

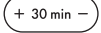
Use the  button to set the desired Timer time in increments of 30 minutes.

Timer can be set a maximum 24 hours.

Set the light intensity to High or Low by using the  button.

#### Normal Mode



#### Timer Mode



Phone: (844) 272-8390  
Email: [info@motifmedical.com](mailto:info@motifmedical.com)  
Web: [www.motifmedical.com](http://www.motifmedical.com)

Manufactured for: Motif Medical®, LLC,  
8 The Green, Suite 5601, Dover, DE 19901



For additional  
resources,  
please scan  
code.

BiliTouch™ *motif*  
MEDICAL